

Main Level

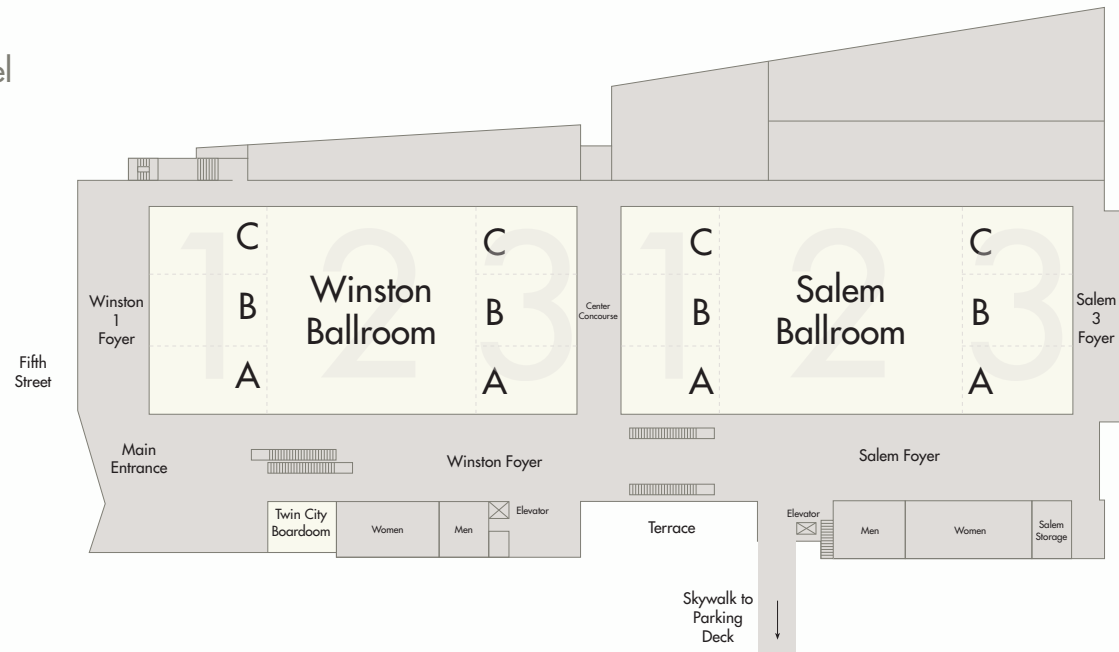

Lower Level

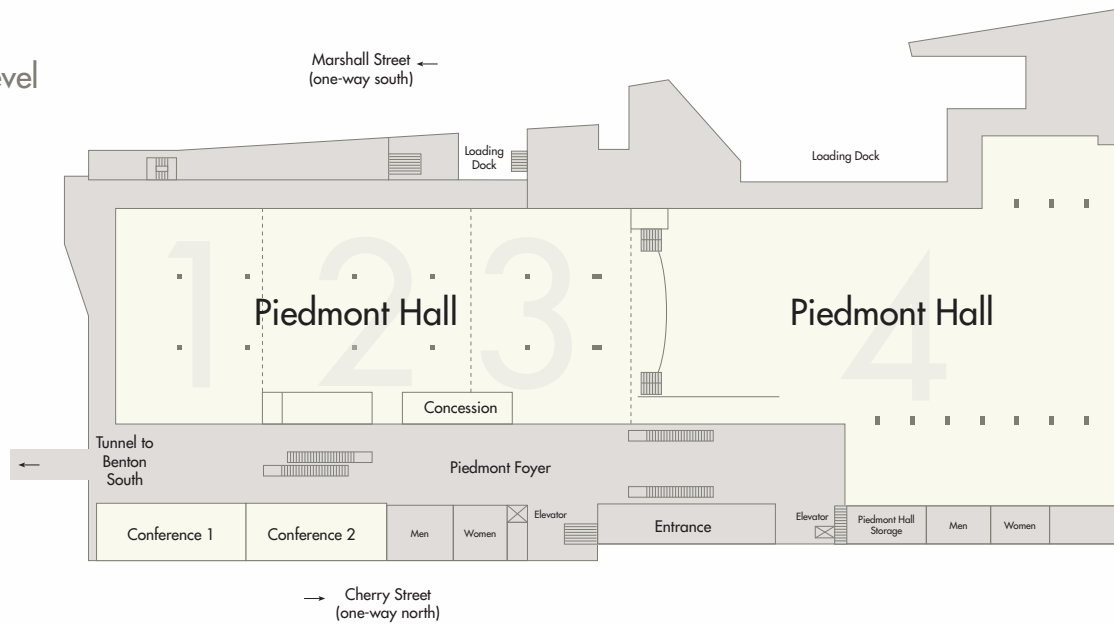

	DIMENSIONS	SQ. FT.	CEILING	THEATER	CLASSROOM	U-SHAPED	HOLLOW SQUARE	RECEPTION	BANQUET 66" ROUNDS	BOARDROOM	EXHIBITS 8' X 10
MAIN LEVEL											
Salem Ballroom	95' x 202'	19,190	18'-25'	2,056	1,002	–	–	1,500	1,200	–	110
Salem Ballroom 2	95' x 112'	10,640	18'-25'	1,140	540	–	–	750	600	–	70
Salem Ballroom 1 (A, B or C)	31' x 43'	1,333	18'	120	60	33	42	70	70	30	–
Salem Ballroom 3 (A, B or C)	31' x 48'	1,488	18'	170	72	40	49	80	80	30	–
Salem Foyer	36' x 202'	–	–	–	–	–	–	1,024	–	–	40
Winston Ballroom	95' x 196'	18,620	16'	1,995	993	–	–	1,500	1,000	–	110
Winston Ballroom 2	95' x 96'	9,120	16'	1,140	540	–	–	700	550	–	70
Winston Ballroom 1 (A, B or C)	31' x 52'	1,612	16'	170	72	40	49	80	80	30	–
Winston Ballroom 3 (A, B or C)	31' x 43'	1,333	16'	120	60	33	42	70	70	30	–
Winston Foyer	36' x 196'	–	–	–	–	–	–	993	–	–	38
Winston 1 Foyer	30' x 95'	–	–	–	–	–	–	80	–	–	10
Twin City Boardroom	17' x 32'	544	9'	–	–	–	–	–	–	14	–
LOWER LEVEL											
Piedmont Ballroom 1, 2, 3 and 4	223' x 208'	46,008	15'-18'	4,822	1,500	–	–	2,400	2,400	–	231
Piedmont Ballroom 1, 2 and 3	84' x 196'	18,300	15'	1,900	650	–	–	950	900	–	100
Piedmont Ballroom 1 and 2	84' x 117'	9,198	15'	1,100	350	–	–	540	540	–	100
Piedmont Ballroom 2 and 3	84' x 141'	12,700	15'	1,450	450	–	–	740	700	–	78
Piedmont Ballroom 1	54' x 84'	3,594	15'	400	140	–	–	200	200	–	22
Piedmont Ballroom 2	63' x 84'	5,604	15'	600	200	–	–	320	320	–	34
Piedmont Ballroom 3	78' x 84'	7,173	15'	825	250	–	–	420	420	–	44
Piedmont Ballroom 4	135' x 208'	27,708	18'	2,893	1,100	–	–	1,440	1,440	–	131
Conference Room 1	21' x 46'	966	9'	100	60	32	36	70	70	–	–
Conference Room 2	21' x 46'	966	9'	100	60	32	36	70	70	–	–

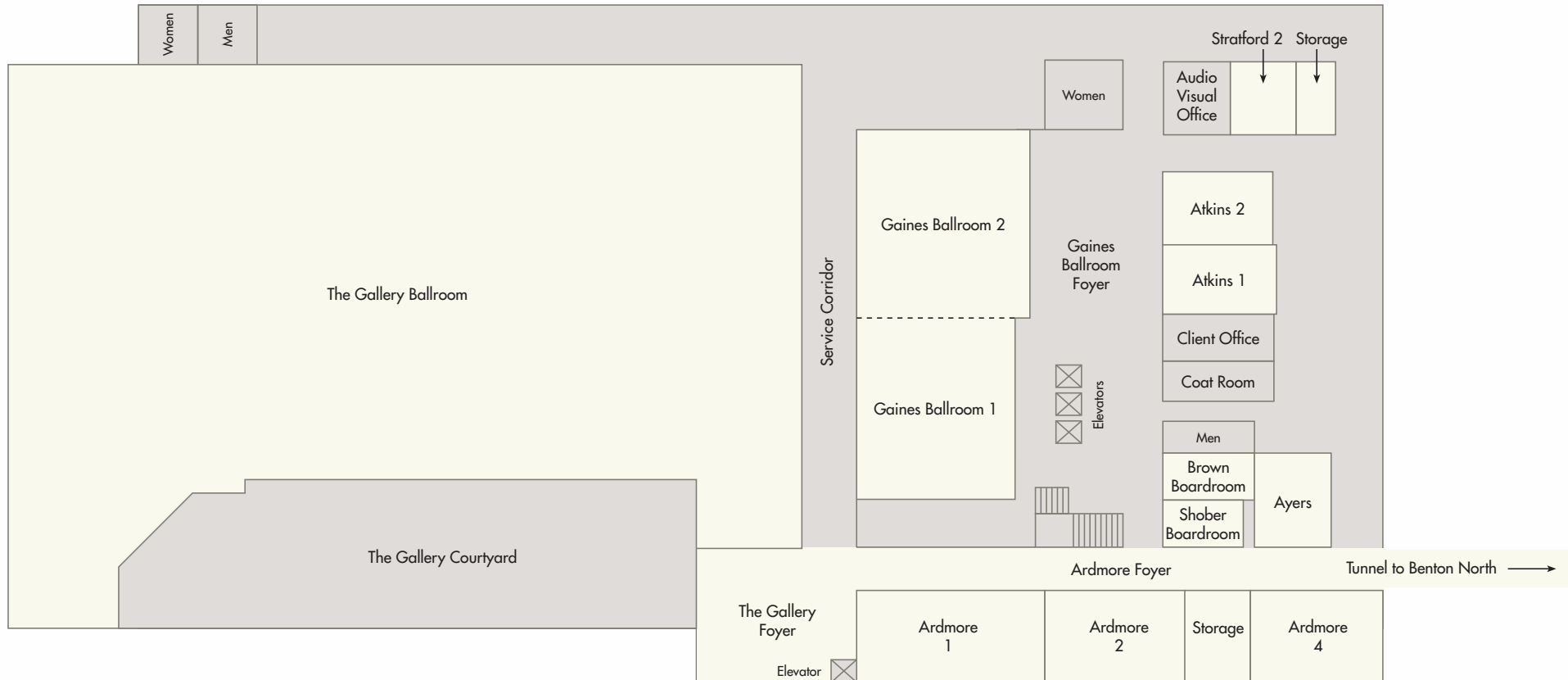

	DIMENSIONS	SQ. FT.	CEILING	THEATER	CLASSROOM	U-SHAPED	HOLLOW SQUARE	RECEPTION	BANQUET 66" ROUNDS	BOARDROOM	EXHIBITS 8' X 10'
Gaines Ballroom	47' x 100'	4,210	10'	375	250	60	80	400	280	–	30
Gaines Ballroom 1	43' x 49'	1,944	10'	150	120	30	30	175	120	–	–
Gaines Ballroom 2	47' x 51'	2,266	10'	150	120	30	30	175	120	–	–
Gaines Ballroom Foyer	36' x 112'	2,400	12'	–	–	–	–	150	–	–	–
Shober Boardroom	13' x 22'	286	10'	–	–	–	–	–	–	10	–
Brown Boardroom	13' x 25'	317	10'	–	–	–	–	–	–	10	–
Atkins 1	20' x 30'	542	10'	30	20	10	10	30	30	–	–
Atkins 2	19' x 31'	546	10'	30	25	15	15	40	40	–	–
Stratford 2	20' x 18'	366	10'	25	15	8	10	35	30	–	–
Ardmore 1	25' x 51'	1,231	10'	100	60	35	40	120	80	–	–
Ardmore 2	25' x 38'	922	10'	80	40	25	30	75	60	–	–
Ardmore 4	25' x 36'	762	10'	40	20	15	18	70	60	–	–
Ayers	21' x 25'	683	10'	30	15	15	15	50	40	12	–
Ardmore Foyer	12' x 125'	1,500	12'	–	–	–	–	–	–	–	–
The Gallery Ballroom	152' x 214'	24,152	11'	2,000	–	–	–	1,200	900	–	118
The Gallery Courtyard	60' x 136'	3,299	22'	–	–	–	–	300	–	–	–
The Gallery Foyer	42' x 60'	1,659	10'	–	–	–	–	50	–	–	–